

5 1/4" Shaft Valve Box Lids

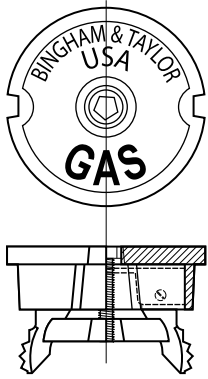

Fig. No. 4904-CI
Locking
Cover

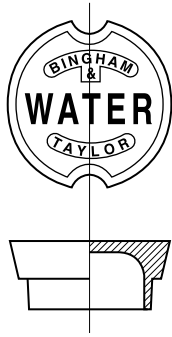

Fig. No. 4905-L1.5
Standard
Round
Drop-In Lid

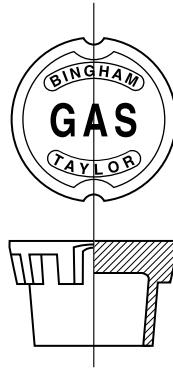

Fig. No. 4905-L2.5
Round
Drop-In Lid
With 2 1/2" Skirt

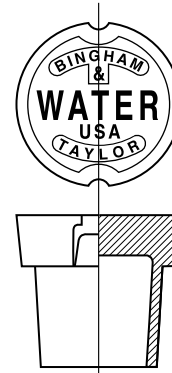

Fig. No. 4905-L4
Round
Drop-In Lid
With 4" Skirt

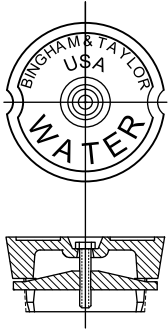

Fig. No. 4904-L
Locking
Cover

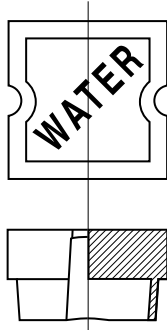

Fig. No. 4905-SQ-L1.5
Square
Drop-In Lid
With 1 1/2" Skirt

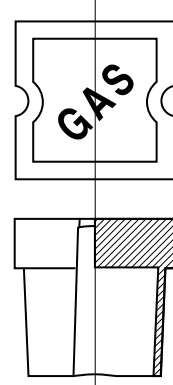

Fig. No. 4905-SQ-L4
Square
Drop-In Lid
With 4" Skirt

Lids available in
gas, water & sewer.
Special markings on
lids are available.

Please inquire.

Figure No. #	Skirt Size	Weight
4904-L	N/A	11 lbs.
4905-L1.5	1 1/2"	13 lbs.
4905-L2.5	2 1/2"	14.5 lbs.
4905-L4	4"	25 lbs.
4905-SQ-L1.5	1 1/2"	14 lbs.
4905 SQ-L4	4"	25 lbs.

Accessories for 5 1/4" 2-Piece Valve Boxes

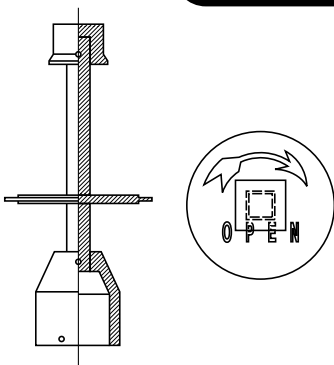

Fig. No. 5051
Valve Stem
Extension Kit

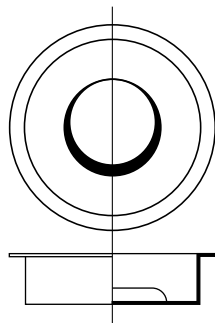

Fig. No. 5052
Debris
Trap

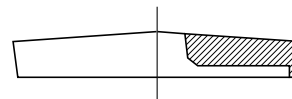

Fig. No. 5060
Rock
Catcher

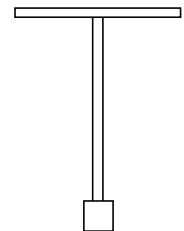

Fig. No. 5050
Valve
Operating Key

Paving Adapters (Risers) for 5 1/4" Shaft Boxes

Fig. No. 6016-B

Standard Adapters

- For use in raising our 5 1/4" shaft Buffalo type valve boxes.
- Cover — 13 lbs.
- **Note:** 1, 1/2" and 2" adapters available with flange.

Figure No.	Size	Weight
6016-B	1"	6.0
6016-B	1 1/2"	10.0
6016-B	2"	11.5
6016-B	2 1/2"	14.0
6016-B	3"	16.0
6016-B	4"	21.0

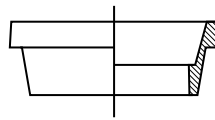

Fig. No. 6016-B
1" Adapter

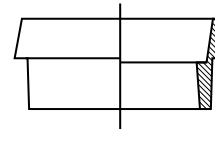

Fig. No. 6016-B
1 1/2" Adapter

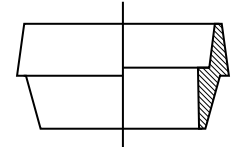

Fig. No. 6016-B
2" Adapter

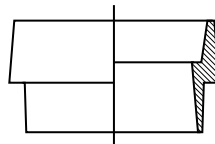

Fig. No. 6016-B
2 1/2" Adapter

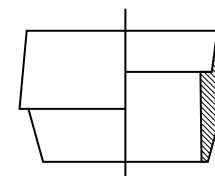

Fig. No. 6016-B
3" Adapter

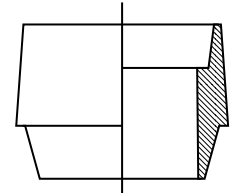

Fig. No. 6016-B
4" Adapter

When Ordering Specify Fig. No. — Type — Raise Desired

Fig. No. 6010
Q-Top Adapter

- This adapter can raise any height from 0"-10".
- Requires special lid.
- Weight — 18 lbs.
- Cover — 9 lbs.

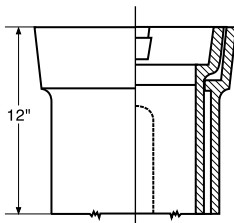

Fig. No. 6010

Fig. No. 6017
P.I. Adapter

- For use with 6" cast iron or plastic pipe to make up a valve box. Uses standard 5 1/4" valve box cover.
- Weight — 17 lbs.
- NOT FOR SCHEDULE 40

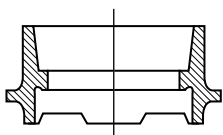
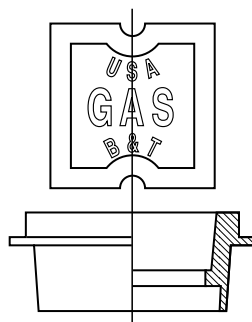

Fig. No. 6017

Fig. No. 6016-SQ
Square Adapters

- For use in raising our 5 1/4" square valve boxes.

Figure No.	Size	Weight
6016-SQ	1"	10
6016-SQ	2 1/4"	14



(Requires special lid.)

Fig. No. 6016-SQ
1" Square Adapter

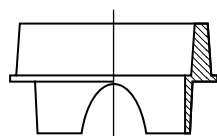

(Uses original lid.)

Fig. No. 6016-SQ
2 1/4" Square Adapter

Fig. No. 6020, 6030
Rite Hite Adapter

- When repaving, this adapter can be used when existing valve box is set too high or too low.
- Adjustable from 2 1/2" to 12". Uses existing box cover.

Figure No.	Length	Weight
6020 Sliding Type	10.5"	15
6020 Sliding Type	15"	22
6030 Screw Type	15"	26

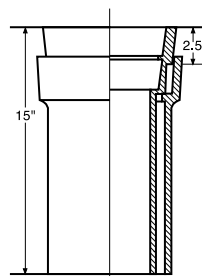

Fig. No. 6020
Sliding Type 15" or 10.5"

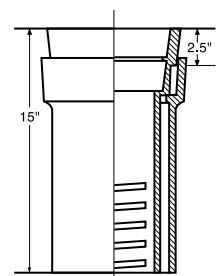
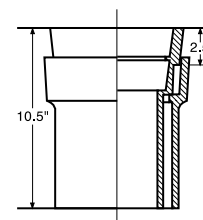

Fig. No. 6030
Screw Type 15"

Fig. No. 2194
Top Hat Adapter

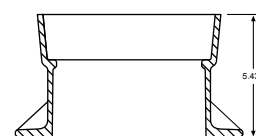

Fig. No. 2194