

# Valve Sentinel

## Security Lock

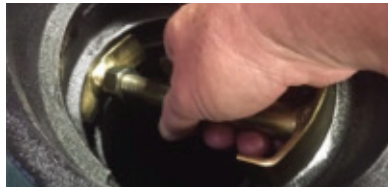

U.S. Pat. No. 9,834,903



Heavy service, high strength valve protection;  
compatible with valve boxes, “Buffalo Style” and larger.

Valve Sentinel is a dual-purpose product for water and gas valves, providing:

- Robust protection from unauthorized access, theft, tampering.
- Easy lock-out/tag-out protection for utilities and municipalities.

### BENEFITS:

- Quick, simple installation.
- Secure with a common open-ended wrench.
- Uses a standard utility-issue padlock.
- Manufactured in yellow, blue, purple, green, red, orange, and black.
- Writable with indelible marker.
- Guaranteed to fit standard domestic and import valve boxes.
- Made from high strength carbon steel.
- Zinc plated mechanism and polyester coated barrier for corrosion resistance.

*“Once it’s  
locked in place,  
it can’t be removed  
without a key!”*



*See reverse for  
ordering information*



**Bingham & Taylor**

Est. 1849



**American  
Iron and Steel  
Institute**



*Certified*  
**WBENC**  
Women's Business Enterprise

Perry Hyde: Director of Sales – Midwest,  
Office #540-825-8334 ext. 117 - Cell #540-229-1882  
phyde@binghamandtaylor.com

Dennis Quinn: Director of Sales – Mid-Atlantic and  
Canada, Office #540-825-8334 ext. 116  
Cell #540-219-4596 - dquinn@binghamandtaylor.com

Mark deLancellotti: Director of Sales – West,  
Office #540-825-8334 ext. 138  
Cell #540-229-2599 mdelance@binghamandtaylor.com

Matt Haan: Director of Sales – Southeast,  
Cell #704-507-2073  
mhaan@binghamandtaylor.com

Brad Washburn: Sales Manager – New England,  
Office #540-825-8334 ext. 137 - Cell #540-229-6008  
bwashburn@binghamandtaylor.com

Brandon Wheeler: Director of Sales – Central,  
Cell # 918-319-7900  
bwheeler@binghamandtaylor.com

# Valve Sentinel Security Lock Components

EXPANDER NUMBER	MODEL	A (MAX BOX)	B (MIN BOX)	C (FULLY COMPRESSED)	D (SHOE WIDTH)	WRENCH SIZE
1	BGBEXP06.50	6½"	5¾"	5⅝"	3"	15/16"
2	BGBEXP07.50	7½"	6½"	6⅜"	3½"	15/16"
3	BGBEXP08.75	8¾"	7½"	7¼"	4"	1¼"
4	BGBEXP10.50	10½"	8¾"	8⅜"	4¾"	1¼"
5	BGBEXP12.75	12¾"	10½"	10"	6"	1¼"

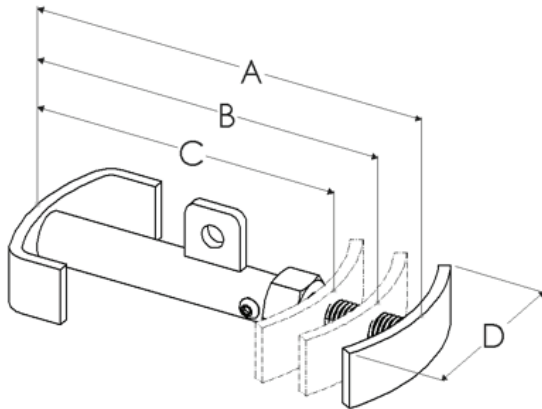

SECURITY PLATE NUMBER	MODEL	DESCRIPTION
1	BGBPLATE-05.75	5-3/4" Diameter Below Ground Barrier Plate
2	BGBPLATE-06.50	6-1/2" Diameter Below Ground Barrier Plate
3	BGBPLATE-07.75	7-3/4" Diameter Below Ground Barrier Plate
4	BGBPLATE-08.50	8-1/2" Diameter Below Ground Barrier Plate
5	BGBPLATE-10.75	10-3/4" Diameter Below Ground Barrier Plate
6	BGBPLATE-11.50	11-1/2" Diameter Below Ground Barrier Plate

## Valve Sentinel Security Lock Sizing Guide

PRODUCT DESCRIPTION	EXPANSION BAR NUMBER	EXPANSION BAR CODE	COVER PLATE NUMBER	COVER PLATE CODE
5-1/4" SLIP VALVE BOXES WATER AND GAS	1	BGBEXP06.50	1	BGBPLATE-05.75
5-1/4" SCREW VALVE BOXES WATER AND GAS	1	BGBEXP06.50	1	BGBPLATE-05.75
SERIES 500 & 600 5-1/4" PLASTIC VALVE BOXES	1	BGBEXP06.50	1	BGBPLATE-05.75
5-1/4" CAST IRON/PLASTIC (CIP) VALVE BOXES	1	BGBEXP06.50	1	BGBPLATE-05.75
# 74, 75 & 76 - 7" SLIP OR SCREW VALVE BOX	3	BGBEXP08.75	3	BGBPLATE-07.75
#107 - 8" CLEAN OUT COVER	3	BGBEXP08.75	2	BGBPLATE-06.50
#178 - SQUARE HEAD DRIP BOX	3	BGBEXP08.75	3	BGBPLATE-07.75
#1975 CLEANOUT BOX	4	BGBEXP10.50	4	BGBPLATE-08.50
MARK V VALVE BOX	4	BGBEXP10.50	3	BGBPLATE-07.75
MARK V TRIANGLE BOX	4	BGBEXP10.50	3	BGBPLATE-07.75
MARK VII VALVE BOX	4	BGBEXP10.50	4	BGBPLATE-08.50
9" PECO VALVE BOX	4	BGBEXP10.50	4	BGBPLATE-08.50
10" RD RIM	4	BGBEXP10.50	4	BGBPLATE-08.50
#199 RD RIM	5	BGBEXP12.75	6	BGBPLATE-11.50
#48 DRIP BOX	5	BGBEXP12.75	6	BGBPLATE-11.50
12" PECO VALVE BOX	5	BGBEXP12.75	6	BGBPLATE-11.50
#200 & #201 11-3/4" SQUARE HEAD VALVE BOX	5	BGBEXP12.75	6	BGBPLATE-11.50
12" RD RIM	5	BGBEXP12.75	5	BGBPLATE-10.75